

SCALE 1 : 300  
STD SHEET NO. 76-C

DEMARICATION, DETAIL AND LEVELLING SURVEY ON LOT 89251,  
MUKIM OF SUNGAI BULOH, DISTRICT OF PETALING,  
SELANGOR DARUL EHSAN

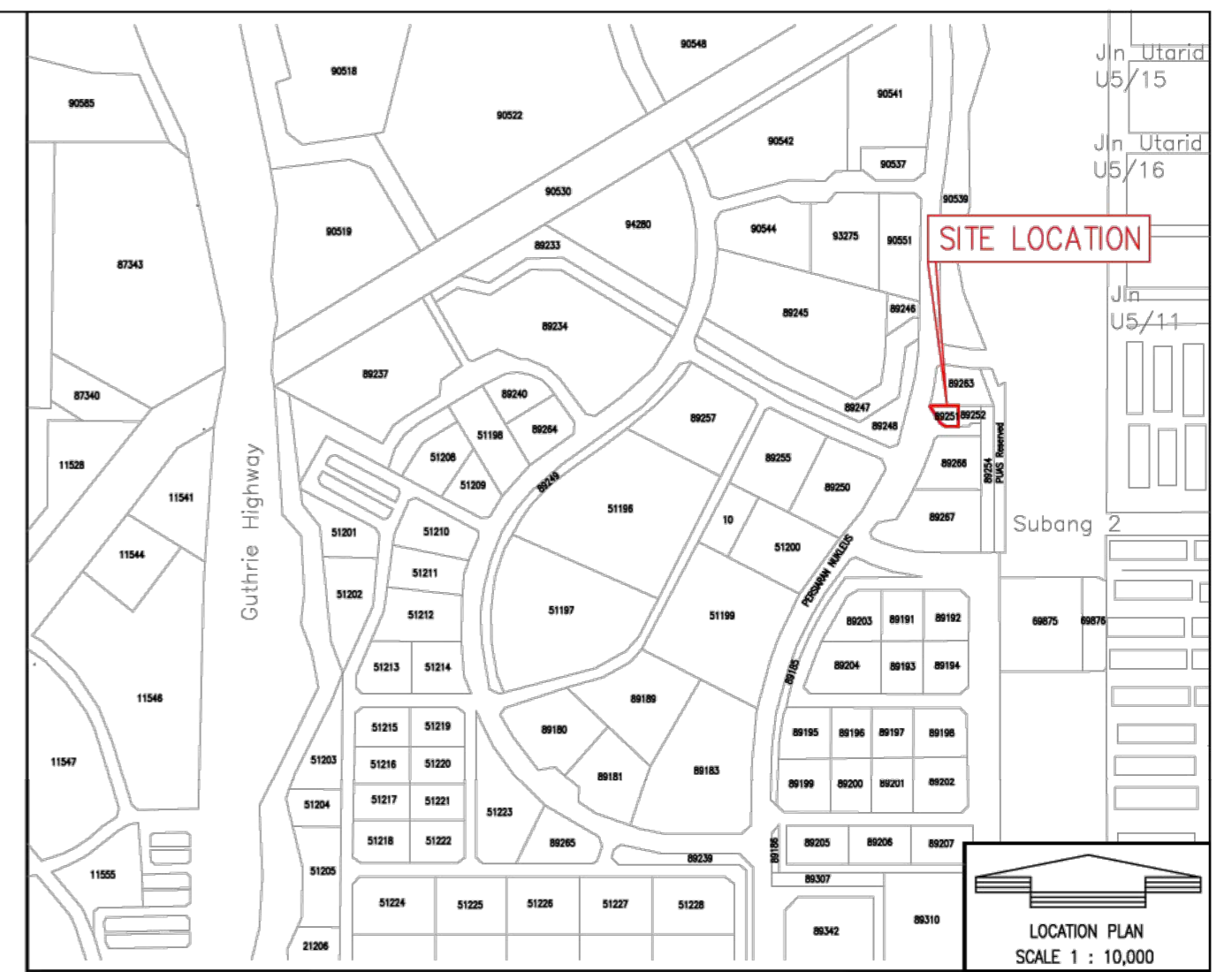

LOCATION PLAN  
SCALE 1 : 10,000

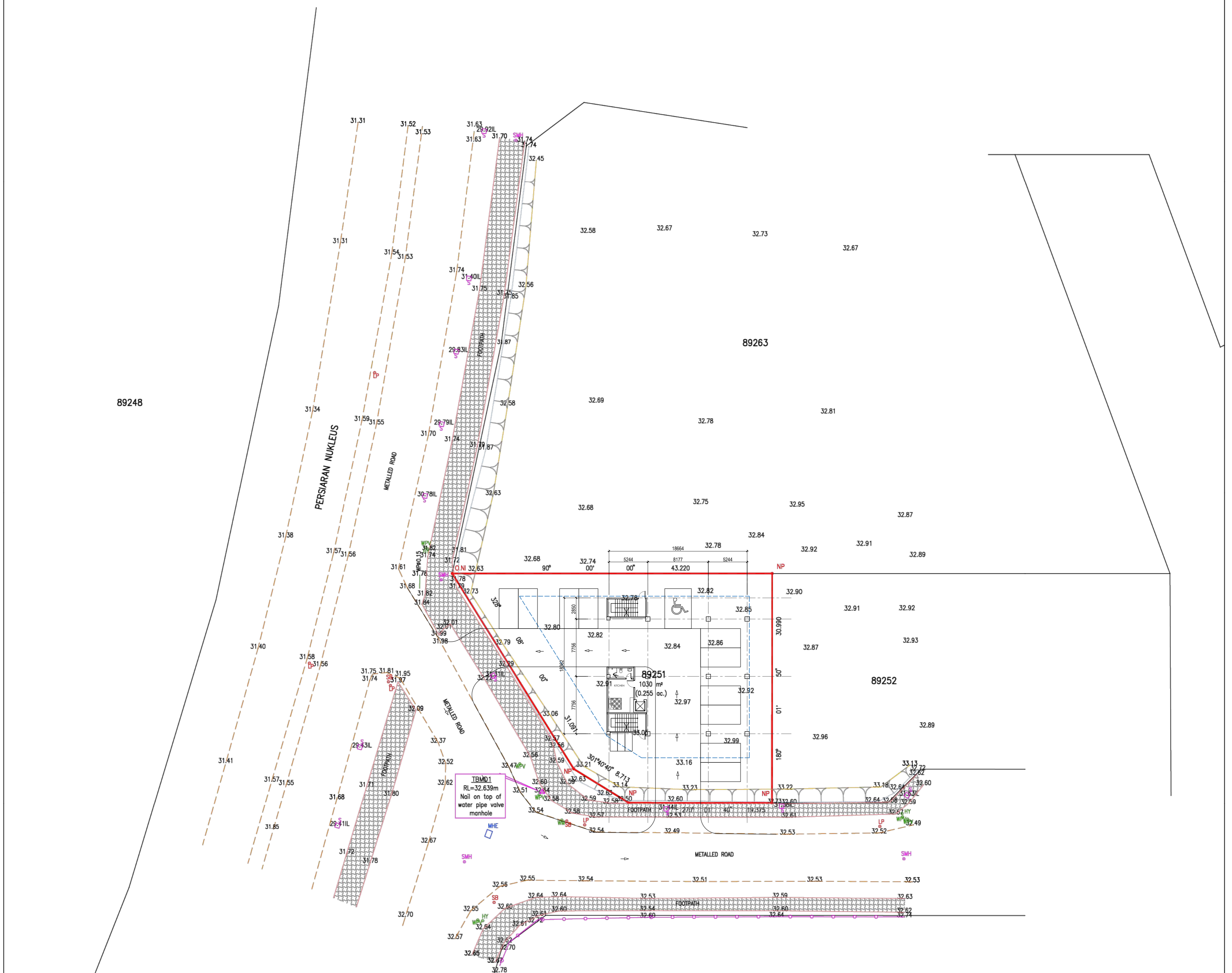

- NOTE :
- 1) ALL LEVELS ARE BASED ON BM 81362 (RL=27.678m).  
AT LEFT HAND SIDE OF SO BULOH - BT TIGA SHAH ALAM,  
AT THE END OF BRIDGE CORNER AFTER CAR SPARE PART SHOP.
  - 2) ALL MEASUREMENTS ARE IN METRE.
  - 3) LEGEND:
- 32.55 - SPOT HEIGHT
  - LP - LAMP POST
  - SB - SIGNBOARD
  - HY - HYDRANT
  - WM - WATER MARKER
  - SMH - SEWERAGE MANHOLE
  - WPV - WATER PIPE VALVE
  - S - SUMP
  - EMH - ELECTRIC MANHOLE
  - IF - IRON FENCE
  - WP#0.15 - WATER PIPELINE
- 4) DEMARICATION IS BASED ON CERTIFIED PLAN NO. 238473.
  - 5) BOUNDARY MARK:
- NP - NEW PIPE
  - DN - OLD NAIL

THIS DEMARICATION SURVEY IS NOT A TITLE SURVEY  
ALL SURVEY BOUNDARY VALUES SHOWN ARE BASED ON CERTIFIED  
PLAN VALUES AS DEMARICATION SURVEY VALUES  
ARE WITHIN ACCEPTABLE LIMIT

SURVEYED BY :	KAMARUDIN	15/04/22
DRAWN BY :	AHMAD	15/04/22
CHECKED BY :	HAIRI	15/04/22
DATA NO. :	L89251.sdr	
WORKFORM :	3818	

**TAN PHAIK CHOON**  
Jurukur Tanah Berlesen  
B. Surv.(Land) (Hons), MISM, MAALS  
Berlesen dibawah Akta 458 (Di semak 1991)

**PINTAR**  
Licensed Land Surveyors

**JURUKUR PINTAR**  
No. 29-5A, 4th Floor, Jalan P.J.U 1/3B,  
SunwayMas Commercial Centre,  
47301 Petaling Jaya, Selangor Darul Ehsan,  
Tel: 03-78803660, Fax: 03-78037804  
Email: jurukurpintar@gmail.com

PLAN NO : 3818/S/2022/A

